

Faceplate Installation Instructions

- 1. Remove faceplate from step unit. Notice the pre-drilled faceplates will have larger 3/8" holes at each end and in the middle. These larger holes will align themselves with pre-set dowels throughout the gasket and into the dead end block. Cut faceplates to correct length. (See Figure 1)
- 2. Before installing the liner, take a 4'x 8' sheet of plywood and nail a 2"x 4"x 8' to plywood and screw a piece of extrusion to the 2"x 4". Plywood conforms to step design. (See Figure 2)
- 3. Lay jig on top of step unit and tape around edge for a good seal for vacuum. (See Figure 3)
- 4. Install liner in normal manner, fitting liner at step area into the plastic extrusion.
- 5. Fill pool until water is approximately 4"- 6" up on the front of the step unit.
- 6. Faceplate side pieces are marked **TL** (top left) and **TR** (top right). Left and Right are determined by facing the step from inside the pool. Starting with bottom horizontal faceplate in hand and with liner in place, find dowels with your finger and place corresponding 3/8" hole over this protrusion. Start in the center first then proceed to left or right side dowels. This will automatically line up all the rest of the pre-drilled screw holes.
- 7. Fasten screws in place starting with holes next to dowels, top and bottom or left and right to center.
- 8. Once all screws are in place, go back and hand tighten. (DO NOT OVERTIGHTEN This can strip the dead end block.)
- 9. Once faceplate is installed, snap cover plate in place. Then slice liner in middle of step to relax material. Cut liner around inside of step faceplate. Remove liner from step. (Save liner section for possible patching material.)
- 10. Finish by placing end-caps over top of faceplate at coping and at each end of bottom horizontal faceplate.

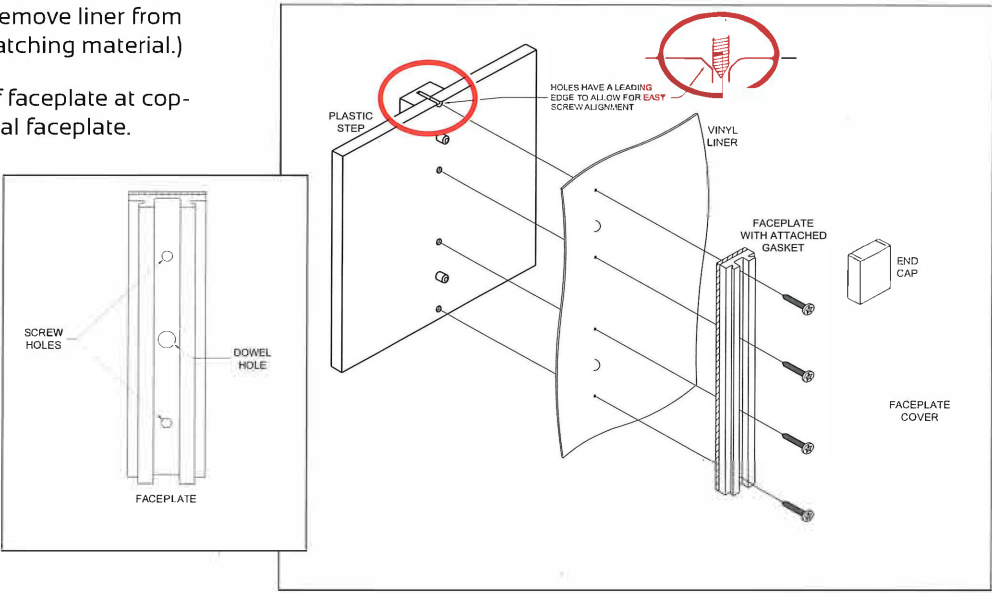
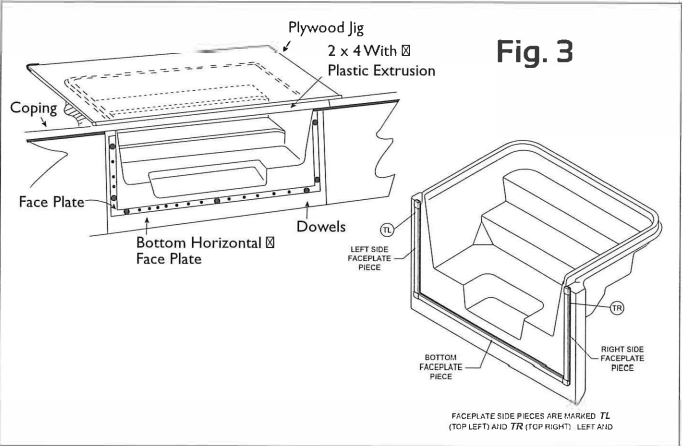
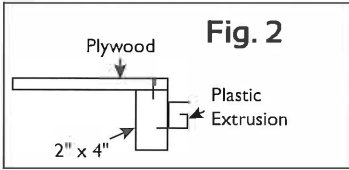
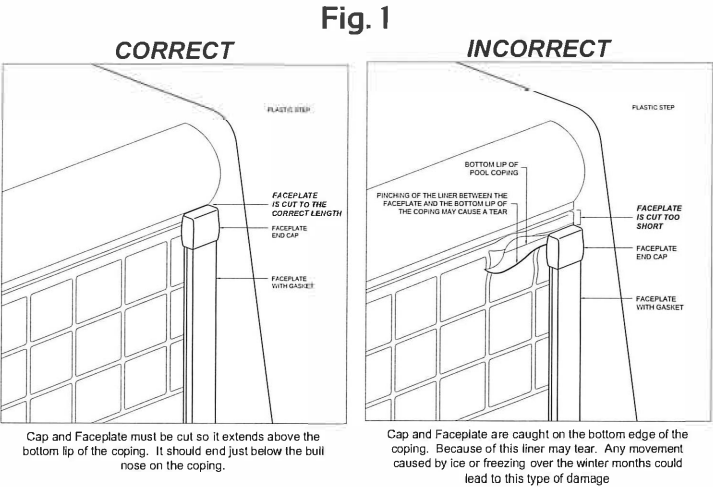

INSTALLATION INSTRUCTIONS
INGROUND POOL STEPS

FEATURING ITS STATE OF THE ART FACEPLATE SYSTEM
WITH CO-EXTRUDED ATTACHED GASKET

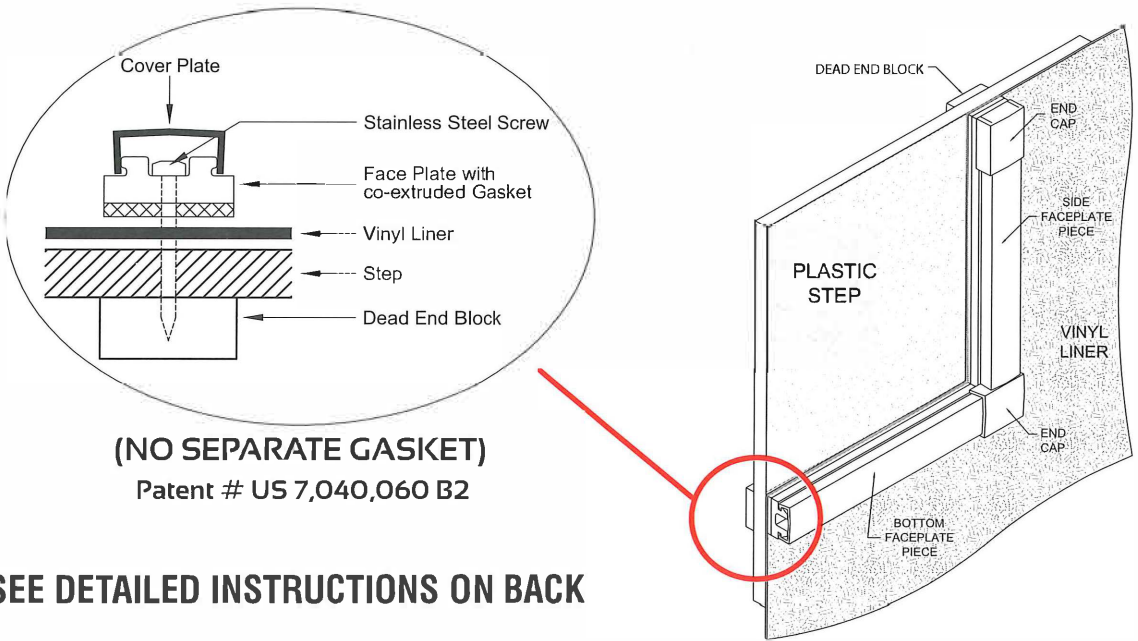

TREAD-LOC® SUPPORT ASSEMBLY INSTRUCTIONS

TREAD-LOC® ASSEMBLY

Tread-Loc® support system
patent # 5752350.

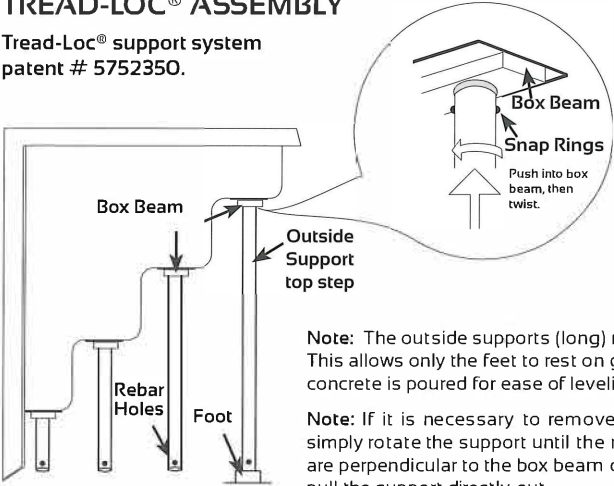

Column Supports are provided in bundles (3 bundles for 8' units and 2 bundles for smaller units). Each bundle contains supports for one row as shown.

Beginning with the long support, depress the snap ring with your thumb and forefinger and insert the support into the receptacle hole on box beam. Rotate the support until the rebar holes are parallel to the box beam channel. Repeat this process for each column in descending order.

Please Note: Outside supports for the top step also have snap rings for bottom to accommodate the foot. All other supports have snap rings on top only and re-bar holes on the bottom.

Repeat this process for each row of column supports until all supports are in place.

Place the support feet on the bottom of the long outside supports for the top step.



33 Wade Road, Latham, NY 12110
800-444-9977 | www.imperialpools.com

STEP PLACEMENT

TRIM-LINE™ COLLAR STEPS: Set step unit between two panels. Adjust height of step by aligning top of coping with top of step (See Figure #1) and plumb by checking front face of step unit with adjoining panels.

Note: Saratoga Steps are universal in height to most coping designs (Bull nose, Flat, etc.) in the pool industry. To insure this, the Saratoga Step comes complete with 4 Styrofoam blocks if needed. These blocks will fill any void between the coping and the step nosing that may appear when lowering the step. (Some cutting of the Styrofoam may be required for a perfect fit.) (See Figure #2)

CANTILEVER STEPS: Set step unit between two panels. Adjust height of step by aligning top flange of panel with top collar of step (See Figure #3) and plumb by checking front of step unit with adjoining panels. Failure in doing this could result in pool having insufficient water level on top step.

Lock step unit in place with vice grip pliers.

Using holes in the panel as a template, drill holes through flange into step and bolt in place with a brace on each side of step unit.

Pour concrete bond beam around pool and step unit. Slope bond beam away from step to ensure proper drainage.

Backfill behind steps before liner installation. Backfilling should be done with sand or gravel (NEVER CLAY), and thoroughly compacted in layers. When finishing pool base in front of step unit, taper it up, and make a slight cove. This will help to relieve any excessive pressure on pool liner. (See Figure #4)

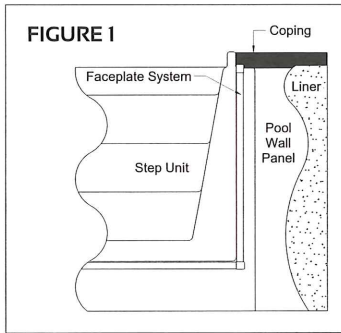

NOTE: A small piece of coping can be used as a measuring guide when placed on the top of the panel.

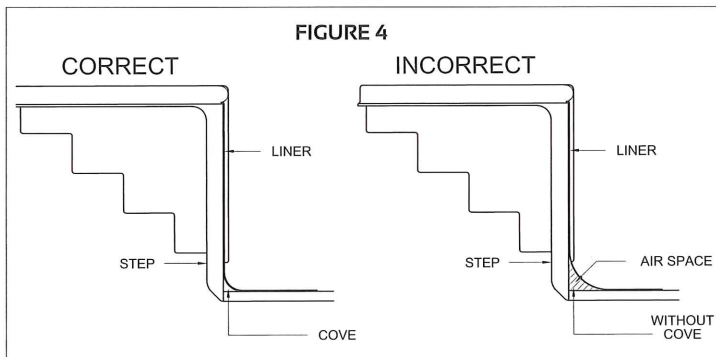
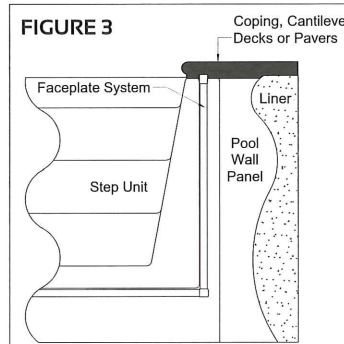
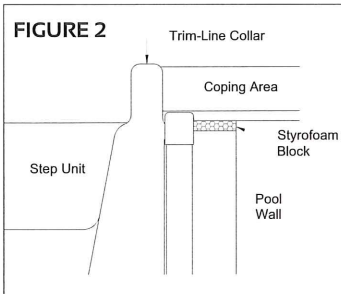

CAUTION

For correct result (photo B), when bolting panel to step, adjust step height to meet top of coping (photo A). Failure to do so will result in an incorrect installation (photo C).

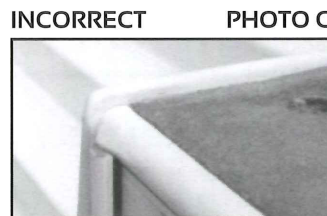
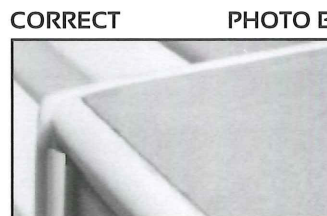
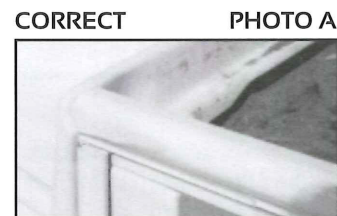

PLACEMENT OF AIR CONTROL ON STEP-N-REST USING JETS WITH 1" AIR SUPPLY

- Drill a 5/16" hole for air control, centered as shown.
- Tighten air control to step wall.
- Spin a 90° reducing elbow (1" x 3/4") to the back of the air control.
- Apply a 1" flex from the control to the jet.

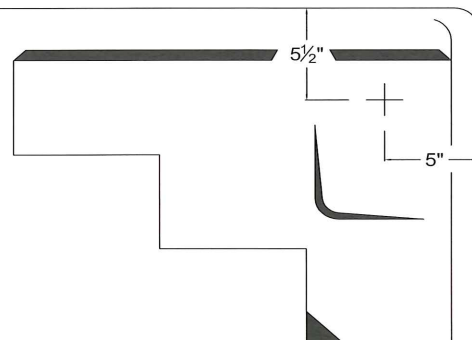

CONCRETE EDGING TIPS

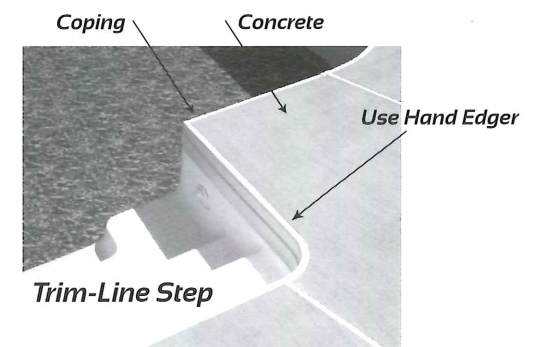
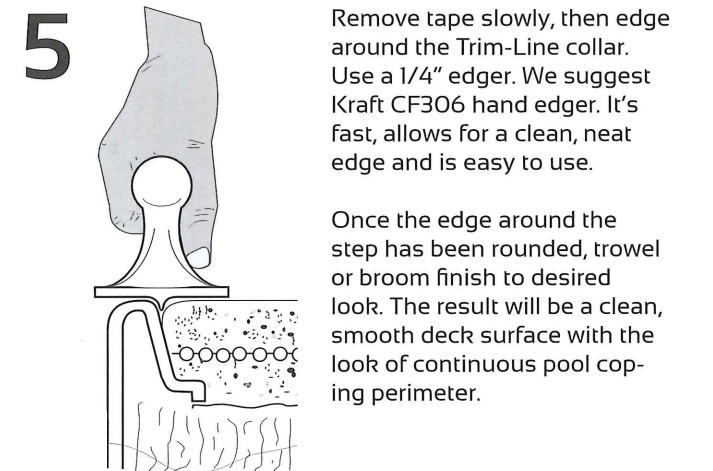
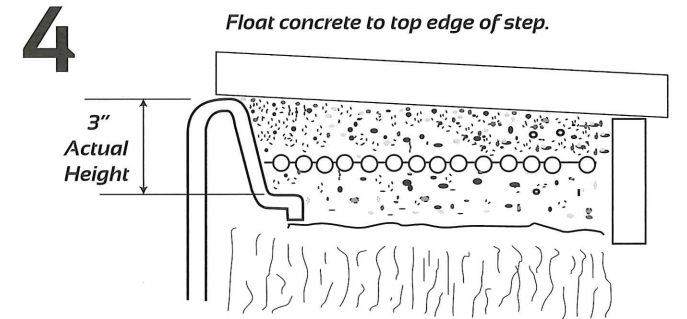
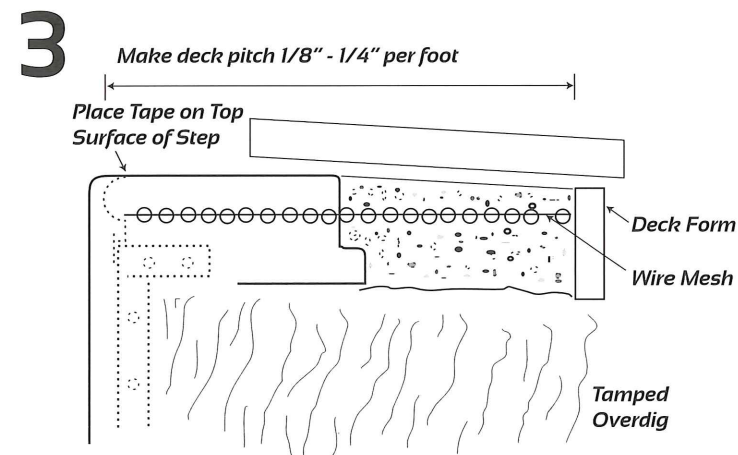
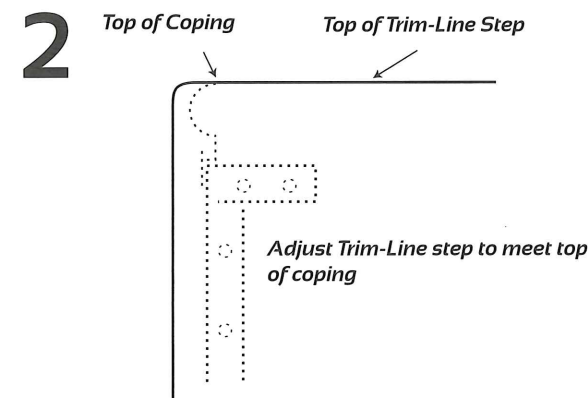
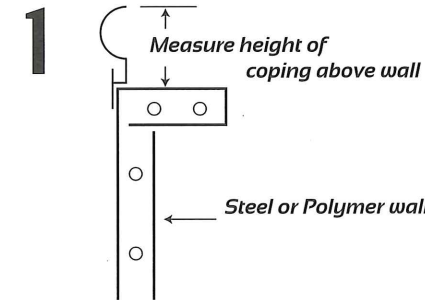

Recommended Tool:



Note: White duct tape suggested, making sure not to leave tape on step for any longer than necessary. Tape can actually "bake" on surface in direct sunlight making clean up difficult.

Concrete tips are for edging purposes only. Proper expansion joints, wire mesh and deck supports are the responsibility of the installer. Manufacturer accepts no responsibility for damage to the step caused by improper installation.

The edging tools shown may be purchased at your local hardware store or contact: Kraft Tool Co. at 913-422-4848 or Fax: 913-422-1018